



3 Polperro Court MORNINGTON VIC

5 2 4

Step into a stunning reimagining of farmhouse elegance nestled on approximately one acre within the coveted Alexandar Park Estate. This exceptional residence blends its humble origins with modern luxury, designed meticulously to enhance your lifestyle.

This home invites you to celebrate the beauty of everyday moments. With elegant European Oak herringbone floors gracing the interiors and a brand-new solar-heated pool creating an indulgent outdoor retreat, sophistication and comfort await you at every turn. Multiple spacious living and dining areas bathe in natural light, each offering its own distinct ambiance. The centerpiece kitchen is a chef's dream, featuring exquisite marble accents and top-tier appliances, including two Miele ovens, a gas cooktop, an

Type : House
Price : \$3,000,000 - \$3,300,000
Land Size : 4000 sqm
View : <https://www.mcewingpartners.com/sale/vic/mornington-peninsula/mornington/residential/house/8148107>

[For full version visit the website](#)



Dean Phillips
0359754555



Lisa Bendle
0359754555

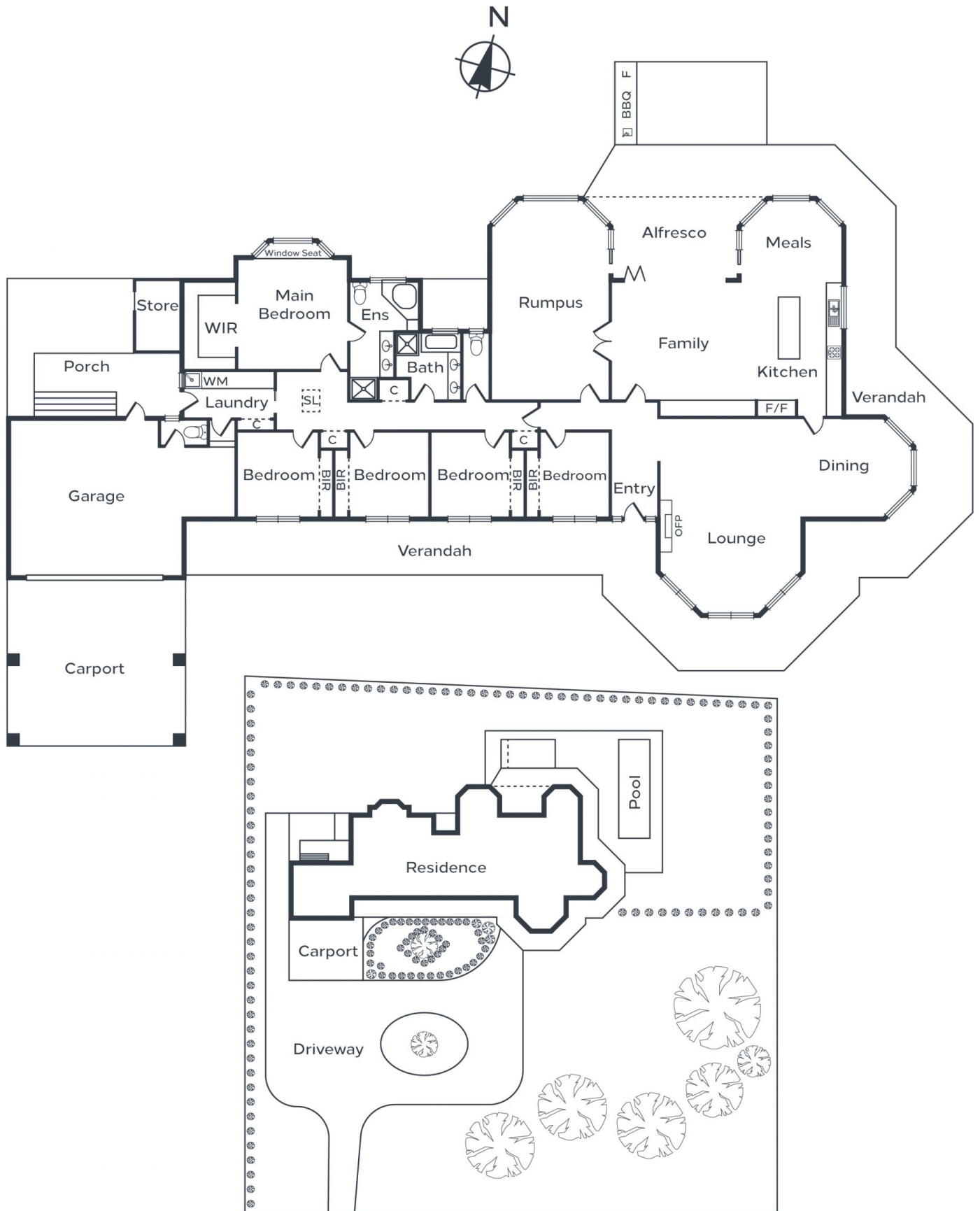

All information is approximate and for illustrative purposes only. WHITEFOX Real Estate provides no guarantees or warranties on accuracy. Interested parties must conduct their own enquiries and verification. WHITEFOX Real Estate disclaims liability for any errors or omissions.