



13 Pennington Close MOUNT ELIZA VIC

4 2 2

APPLICATION APPROVED

Introducing 13 Pennington Close, Mt Eliza - Architectural appeal and versatile living. Nestled in a tranquil cul-de-sac and within easy reach of the local primary school, this remarkable property is designed with family in mind. Subtle mid-century elements infuse a touch of funk into the meticulously crafted space.

Step inside and be greeted by dark stained floors and soaring ceilings, creating a sense of depth within the bright and airy interior. The striking split-level design effortlessly connects multiple living and dining areas, flowing seamlessly from the heart of the home - a central stone kitchen adorned with European appliances.

This exceptional property boasts 3-4 beautifully fitted bedrooms, including a master suite complete with an

Type : House

View : <https://www.mcewingpartners.com/lease/vic/bayside/mount-eliza/residential/house/7612326>



Samantha Stephenson
0397872422

[For full version visit the website](https://www.mcewingpartners.com)

13 Pennington Close, Mount Eliza

4 Bed 2 Bath



LEGEND

1. Driveway
2. Verandah
3. Deck
4. Outdoor Seating

Internal : 245m²
External : 40m²



GROUND FLOOR

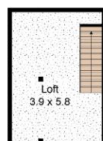

FIRST FLOOR

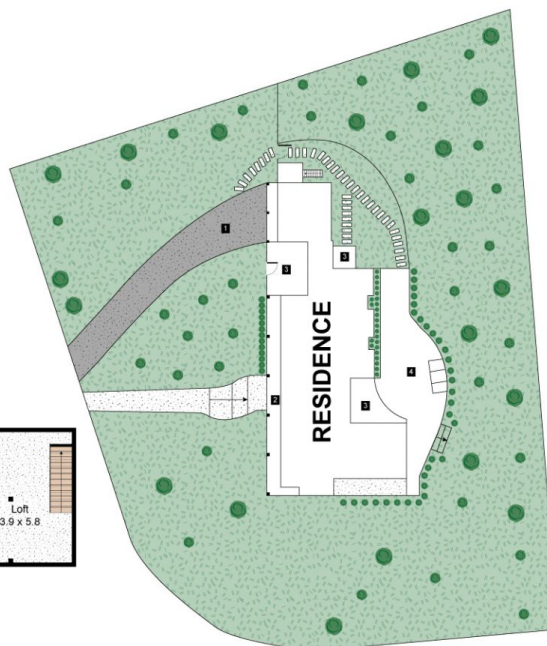

SITE PLAN

